

建筑范例解读与分析

周国帆 曹宇

Stonehenge Exhibition and Visitor Centre



Coach Park

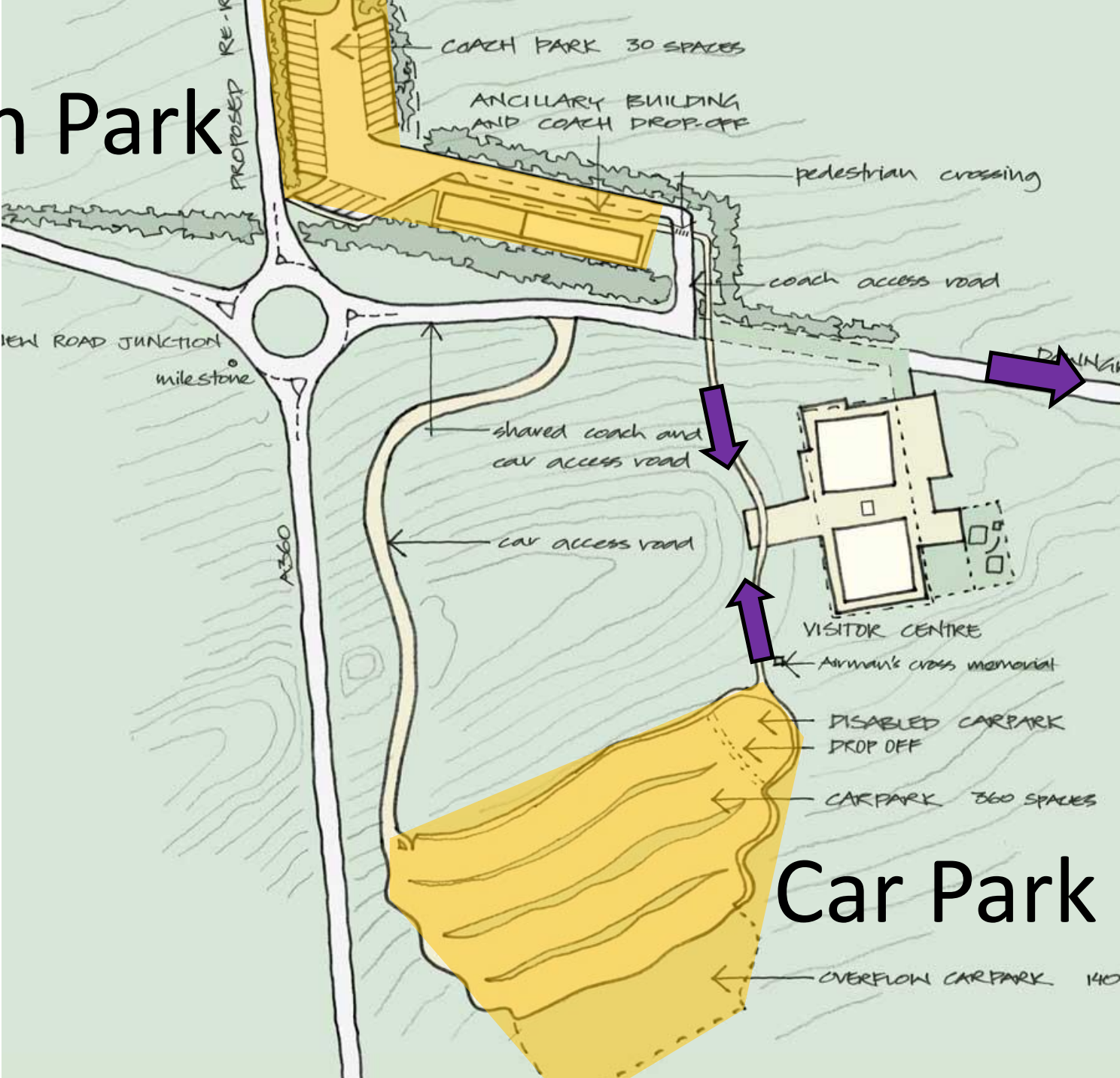

Car Park

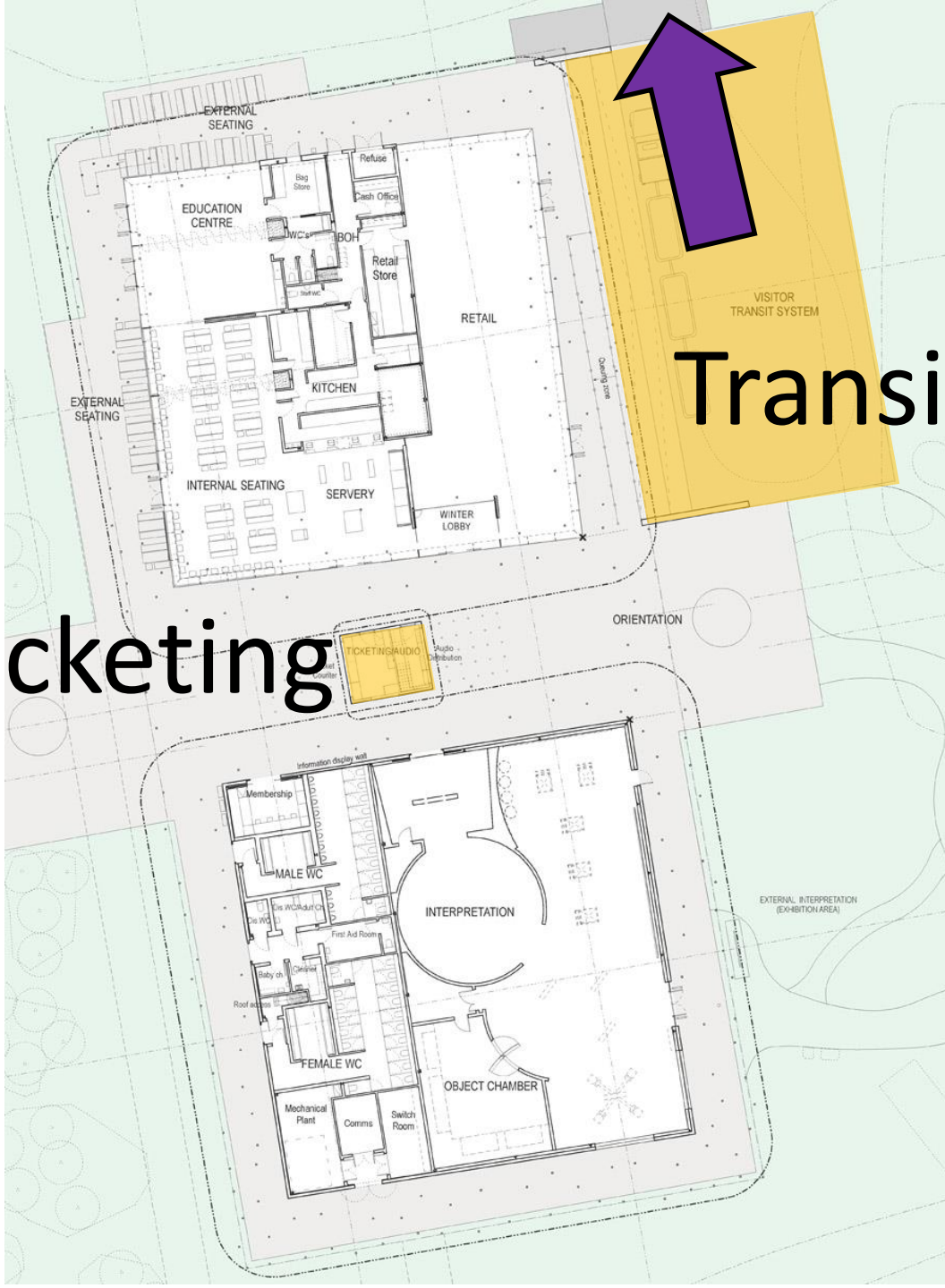

Transit Park

Ticketing

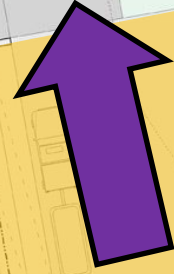
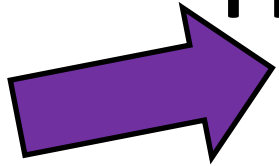

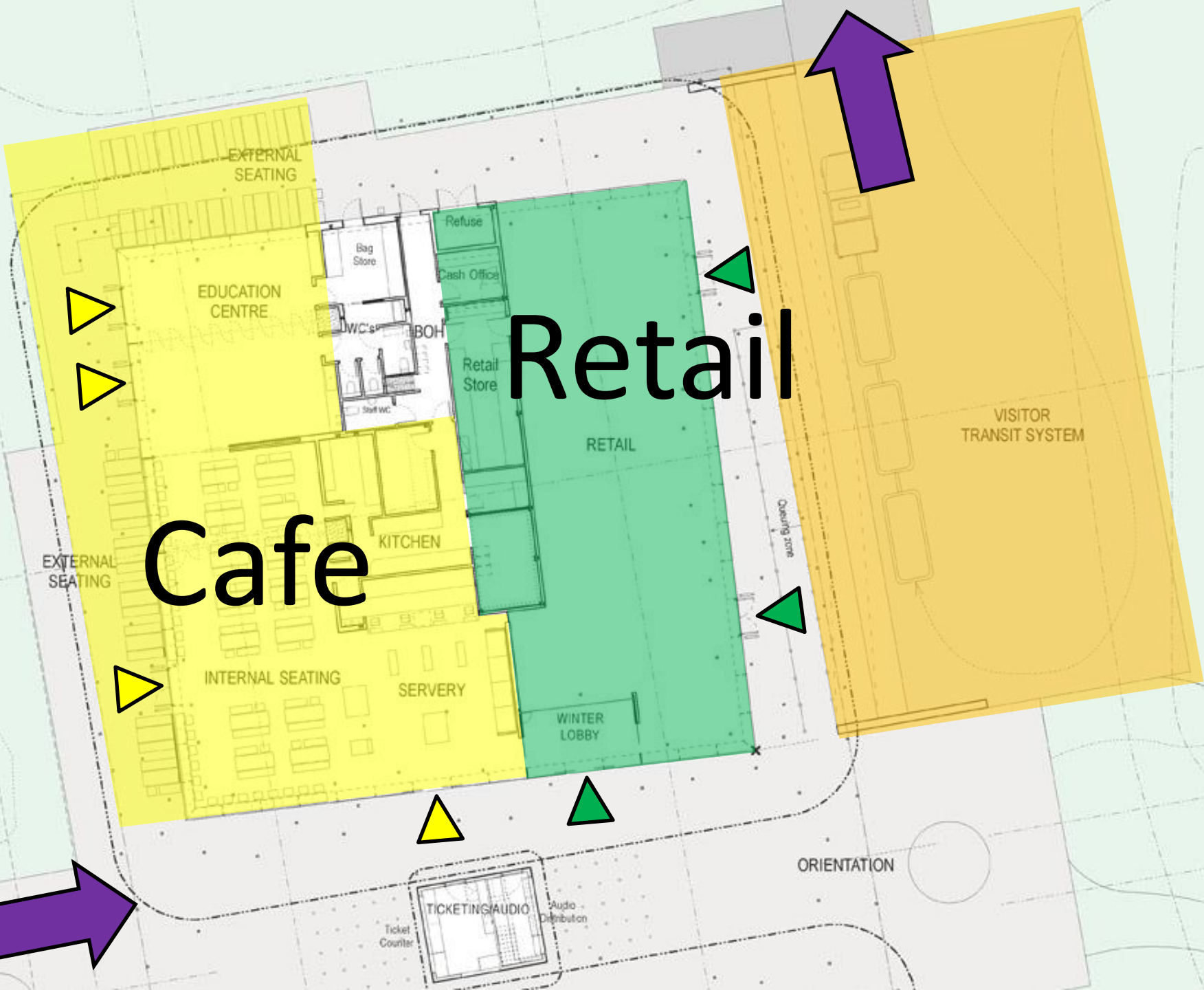

Retail

Cafe

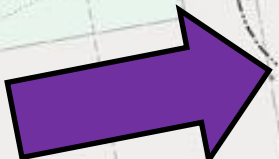

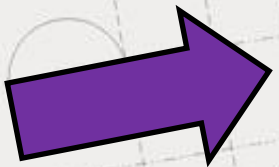

ORIENTATION



Toilets

Display



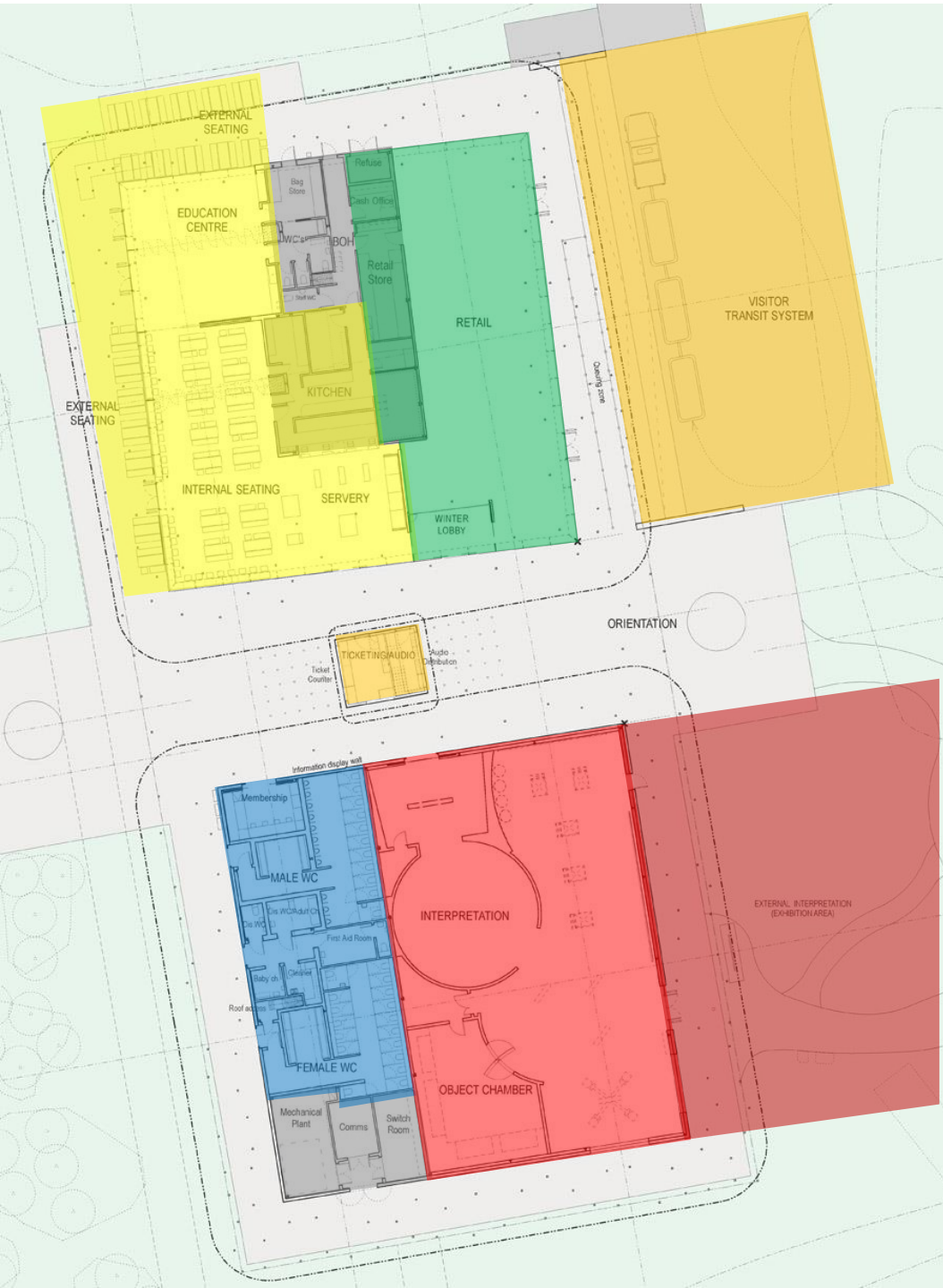

① 内外有别

② 动静分区

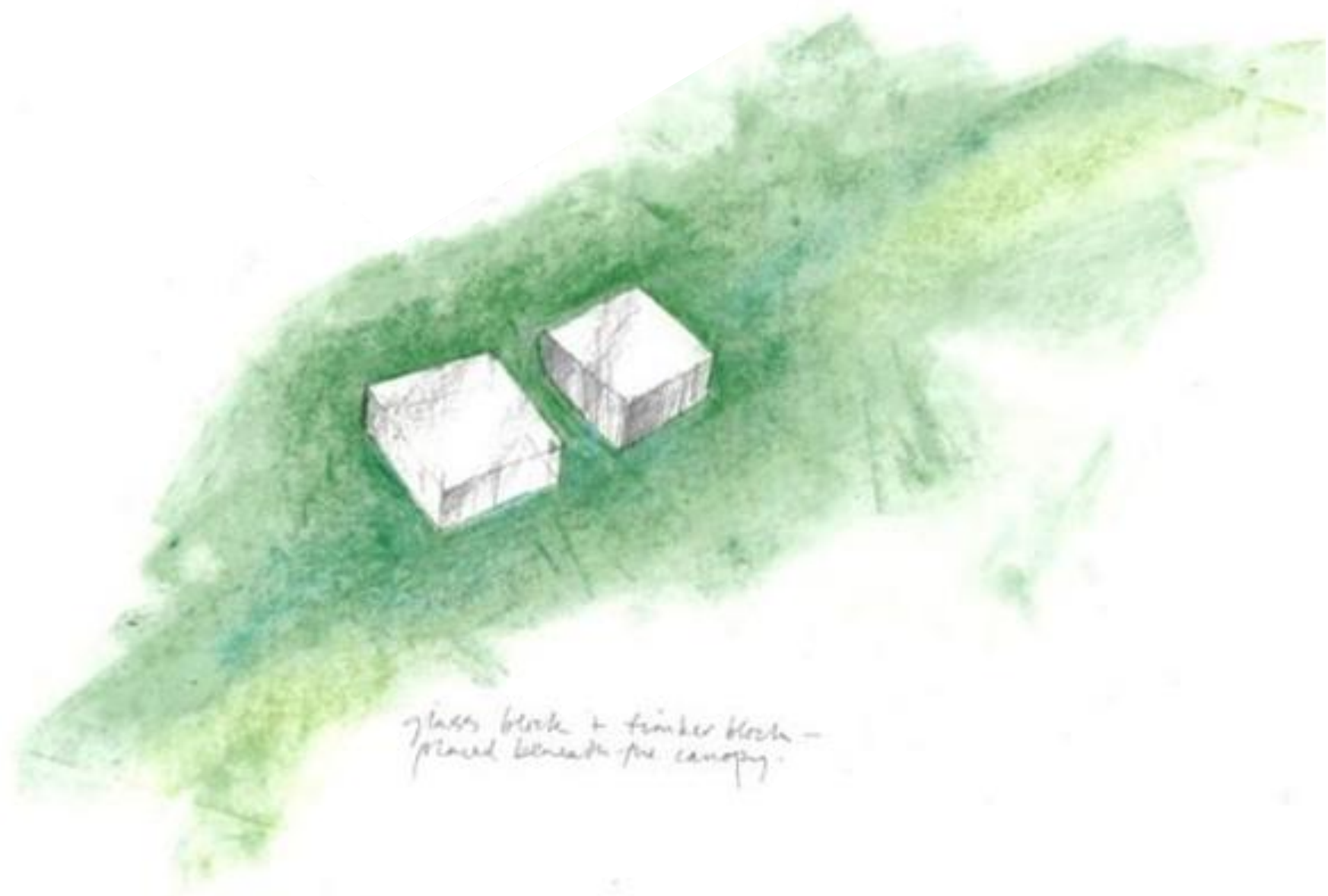

glass block + timber block -
placed beneath the canopy.

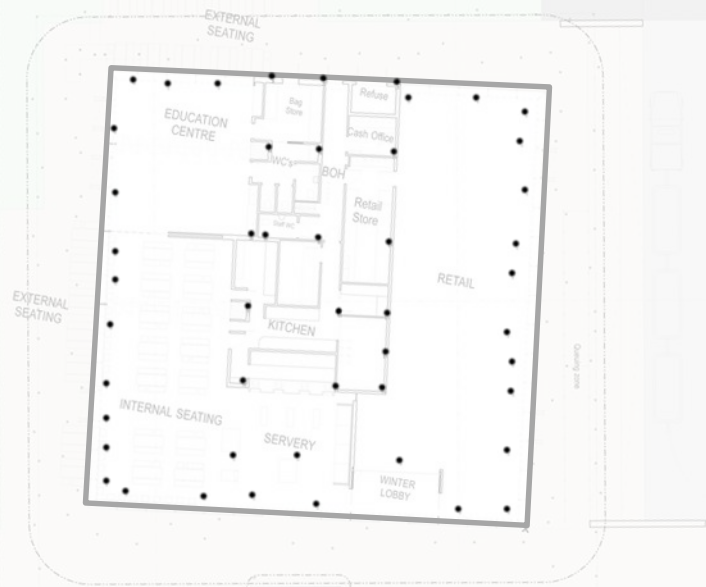

ORIENTATION

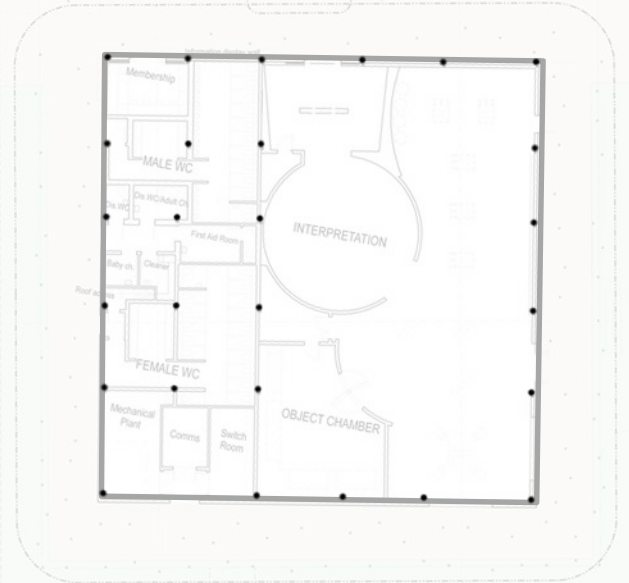

A

B

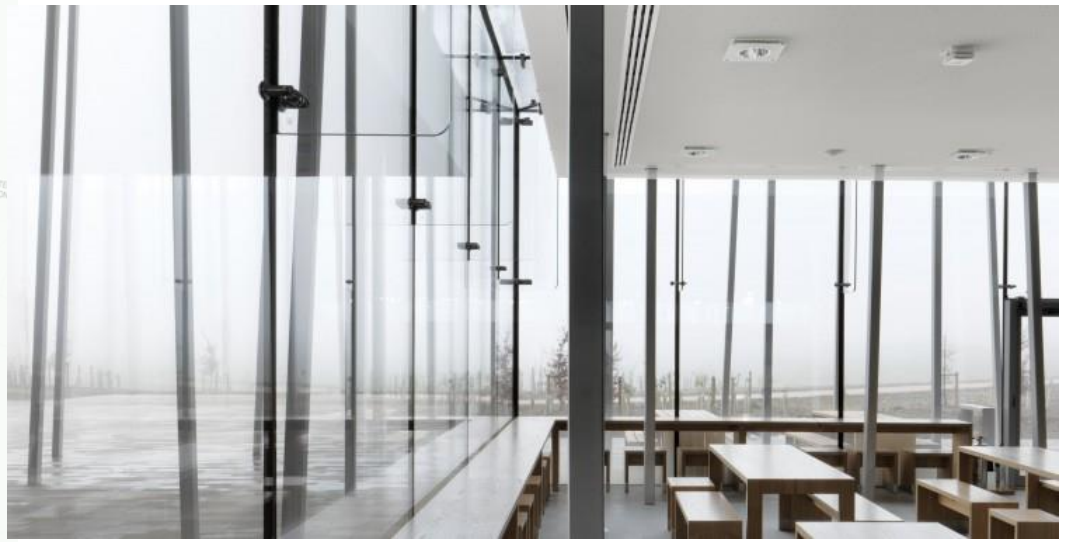

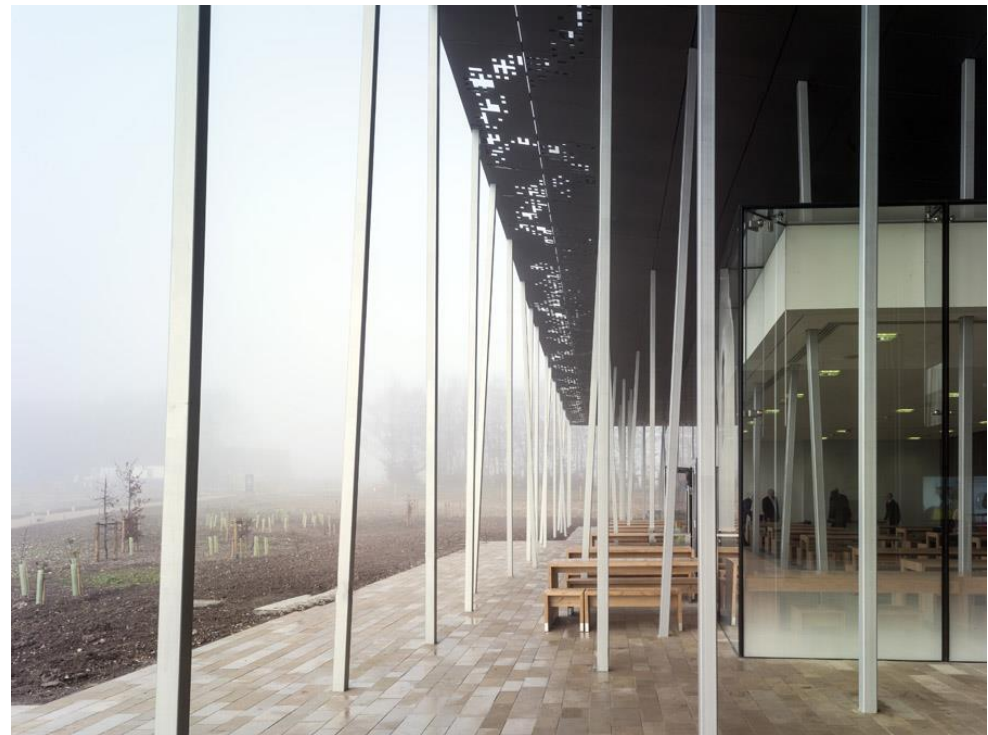
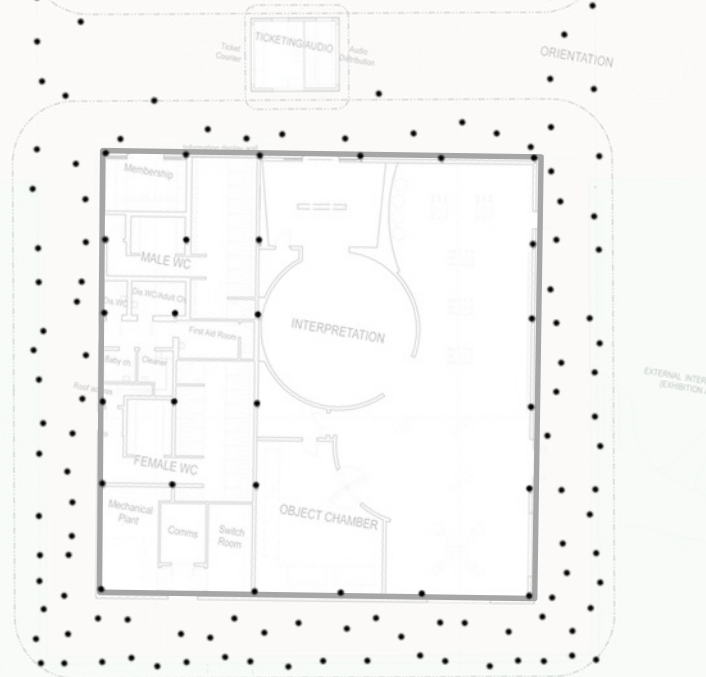
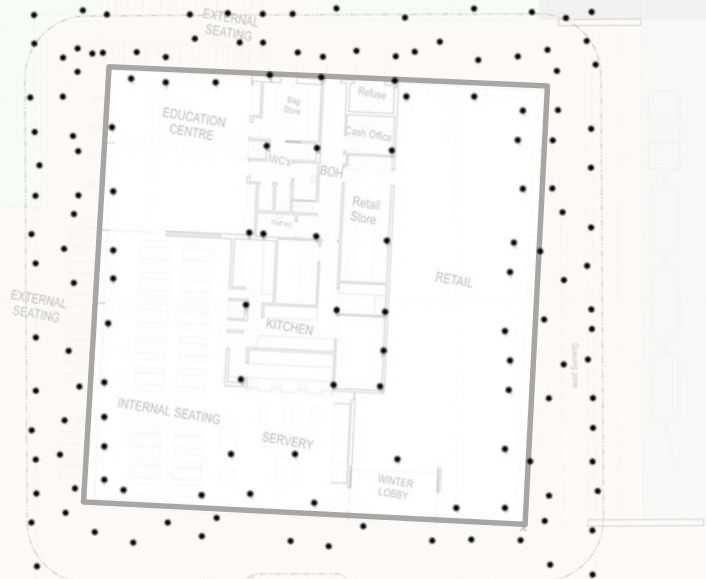

A

B

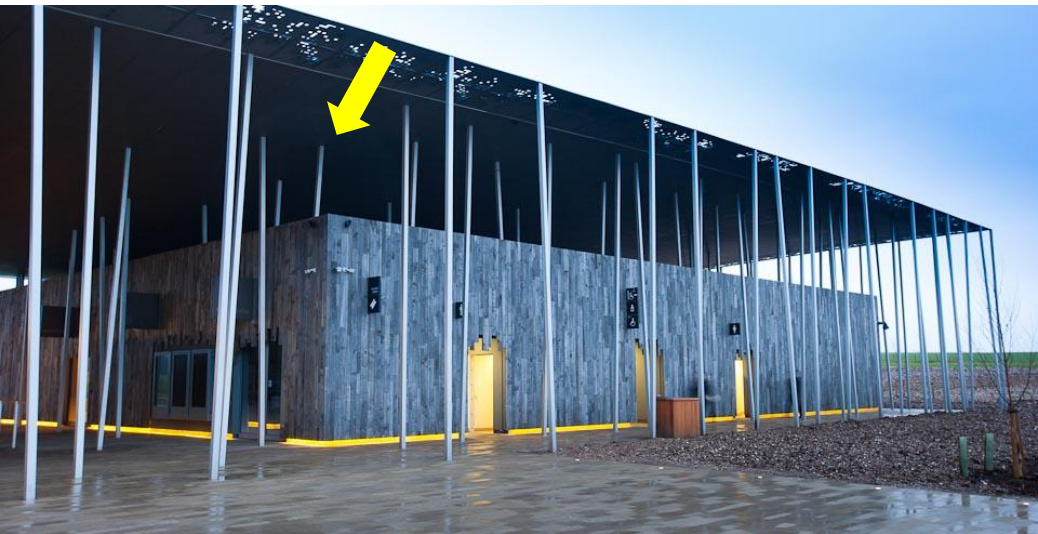
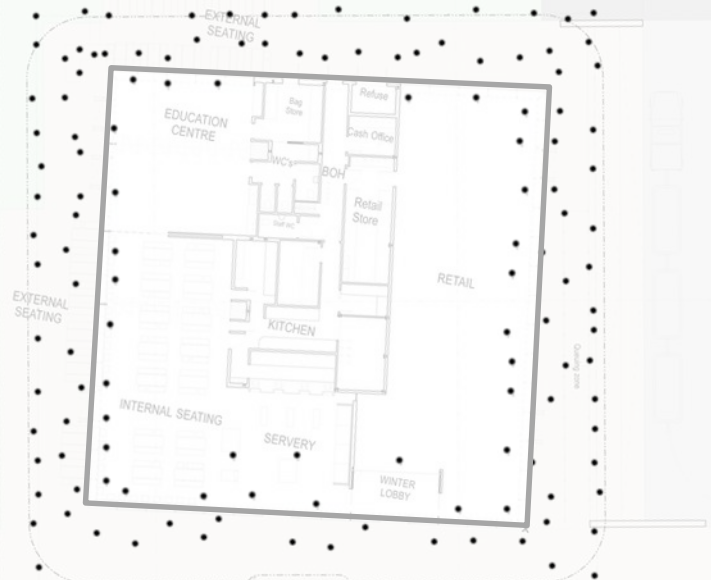



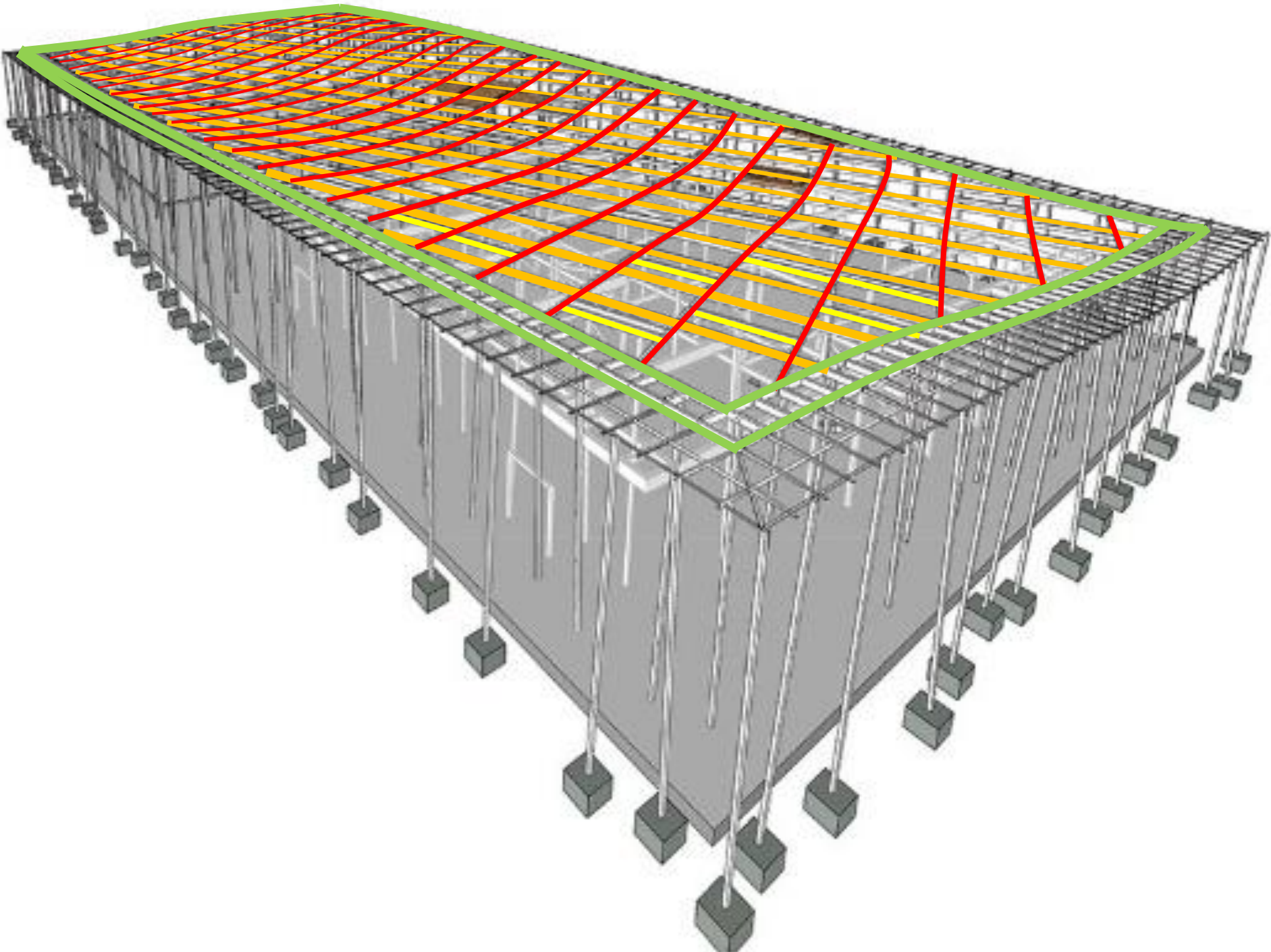





a single-ply membrane



zinc panels

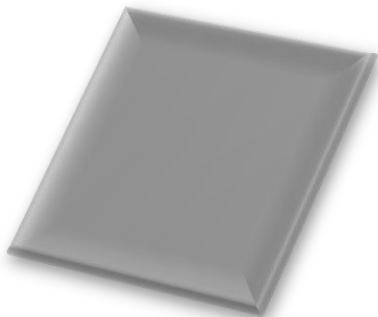

938mm square
4mm-thick
3,268 panels

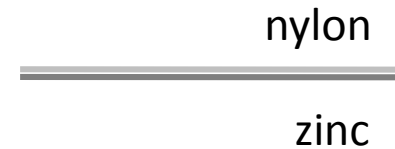



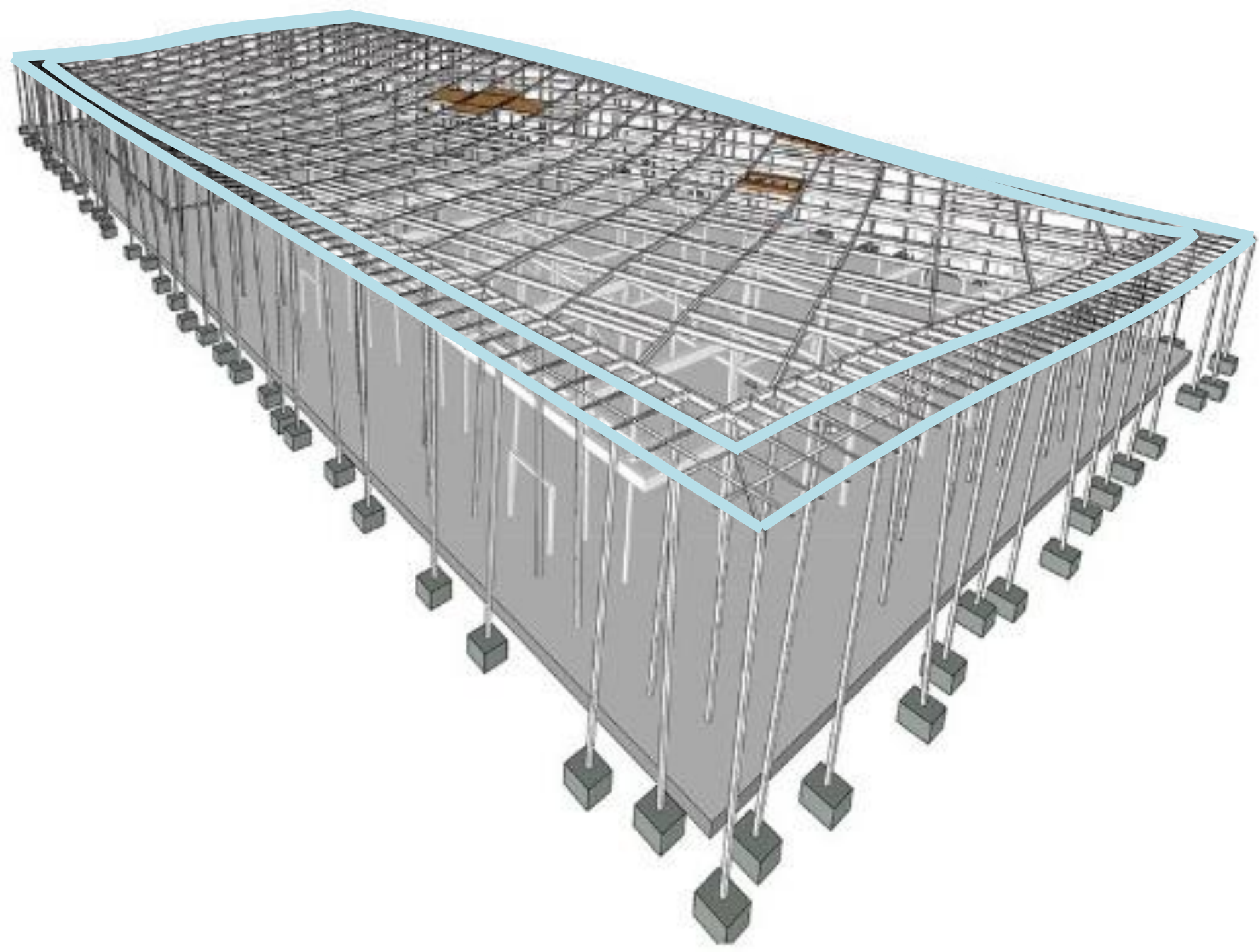





参考网站与书目

- <http://www.sarsen.org/2013/05/stonehenge-visitor-centre-lot-of-history.html>
- <https://mikepitts.wordpress.com/category/stonehenge/page/2/>
- Macarthur, John. *Architecture Australia*. Jul/Aug 2014, Vol. 103 Issue 4, p20-27. 8p.
- *Architectural Record*. June 2014, p217-221. 5p.

Thank you

Q & A