

案例分析

——Primetime Nursery School



解读回顾

- 体块形成
- 空间布局（回旋坡道）
- 功能布局



前情回顾

体块形成

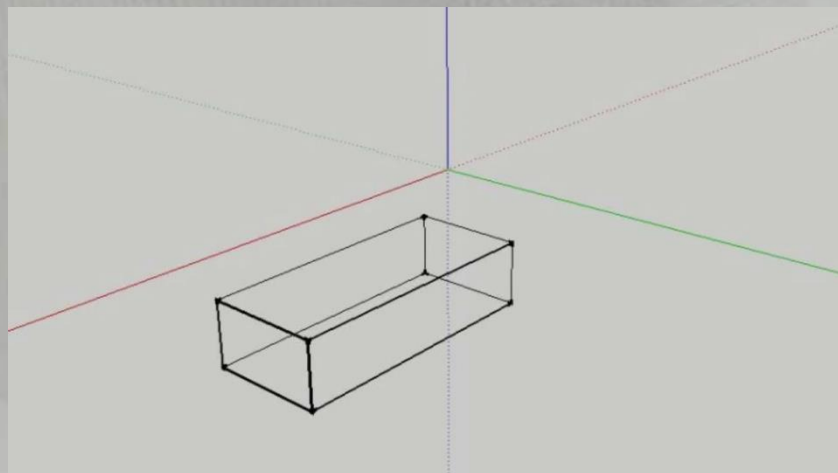

前情回顾

○ 空间布局（回旋坡道）

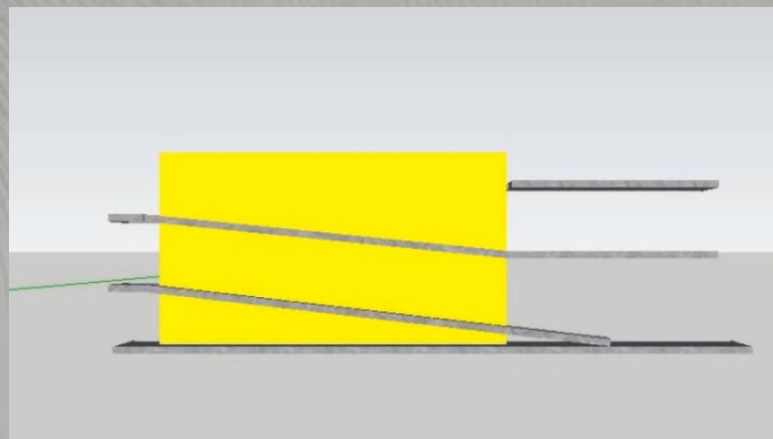







前情回顾

○ 功能布局



PLAN ground floor
scale 1:200

- | | | | |
|---|----|---|----|
|  | 活动 |  | 休息 |
|  | 储藏 |  | 厕所 |
|  | 后勤 |  | 办公 |

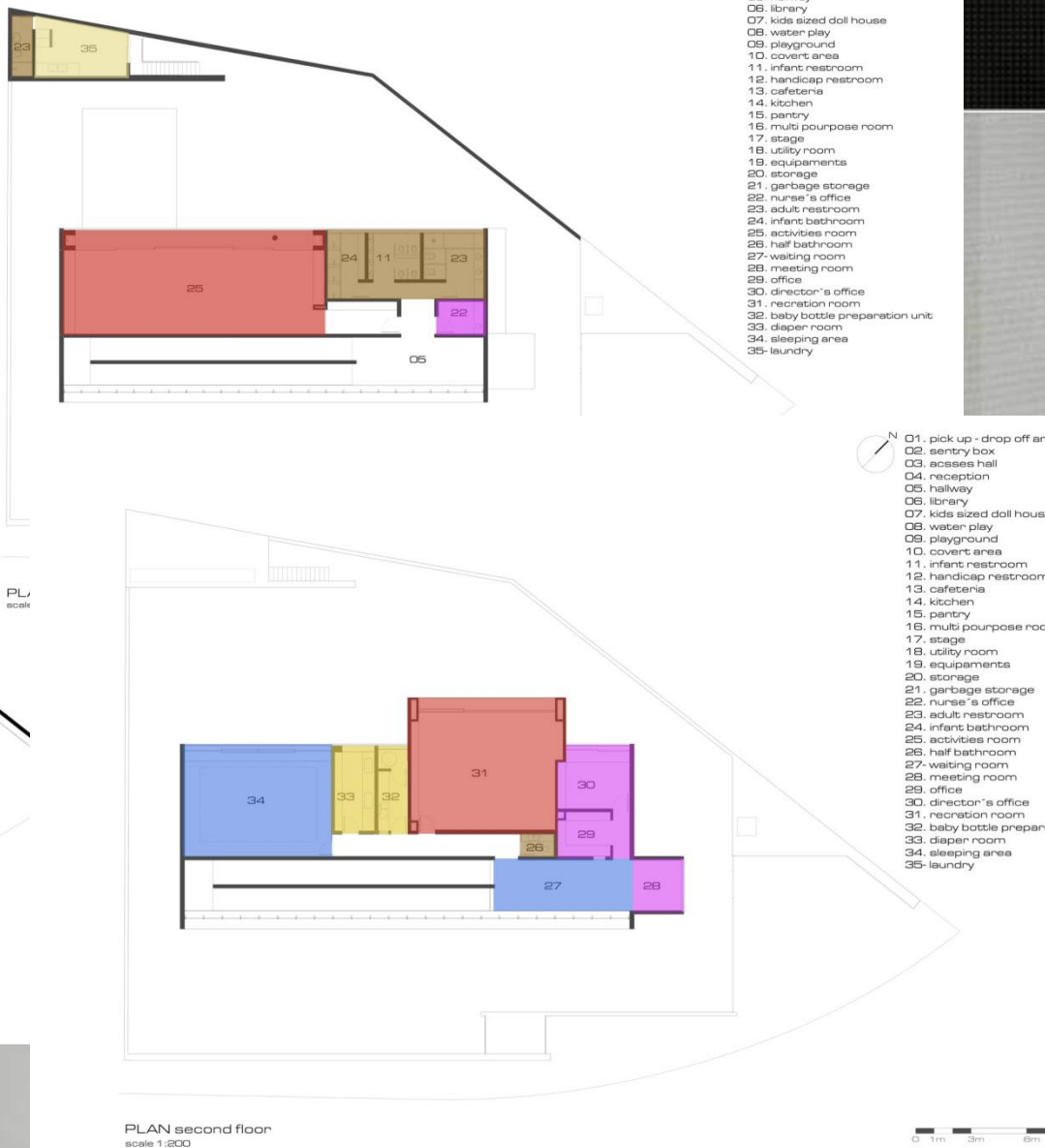

PLAN second floor
scale 1:200

- 02. sentry box
- 03. access hall
- 04. reception
- 05. hallway
- 06. library
- 07. kids sized doll house
- 08. water play
- 09. playground
- 10. covert area
- 11. infant restroom
- 12. handicap restroom
- 13. cafeteria
- 14. kitchen
- 15. pantry
- 16. multi purpose room
- 17. stage
- 18. utility room
- 19. equipments
- 20. storage
- 21. garbage storage
- 22. nurse's office
- 23. adult restroom
- 24. infant bathroom
- 25. activities room
- 26. half bathroom
- 27. waiting room
- 28. meeting room
- 29. office
- 30. director's office
- 31. recreation room
- 32. baby bottle preparation unit
- 33. diaper room
- 34. sleeping area
- 35. laundry

- 01. pick up - drop off area
- 02. sentry box
- 03. access hall
- 04. reception
- 05. hallway
- 06. library
- 07. kids sized doll house
- 08. water play
- 09. playground
- 10. covert area
- 11. infant restroom
- 12. handicap restroom
- 13. cafeteria
- 14. kitchen
- 15. pantry
- 16. multi purpose room
- 17. stage
- 18. utility room
- 19. equipments
- 20. storage
- 21. garbage storage
- 22. nurse's office
- 23. adult restroom
- 24. infant bathroom
- 25. activities room
- 26. half bathroom
- 27. waiting room
- 28. meeting room
- 29. office
- 30. director's office
- 31. recreation room
- 32. baby bottle preparation unit
- 33. diaper room
- 34. sleeping area
- 35. laundry

0 1m 3m 6m

深入分析

- 地理位置
- 用地分析
- 平面生成
- 流线及空间
- 色彩探究

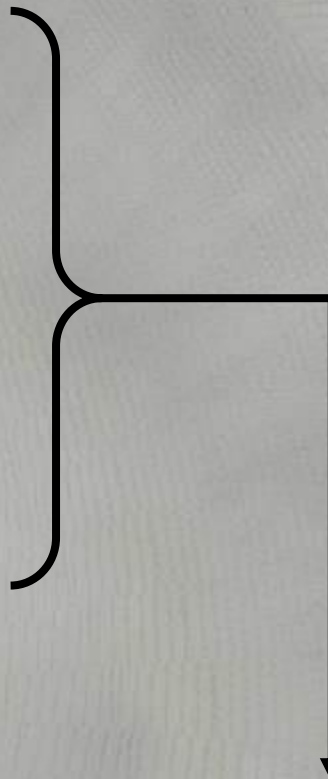

为儿童设计为线

位置环境

- 幼儿园位于市里某居民区附近，环境相对安静，适宜幼儿园的建设。建筑用地较为平坦，不存在高度差。

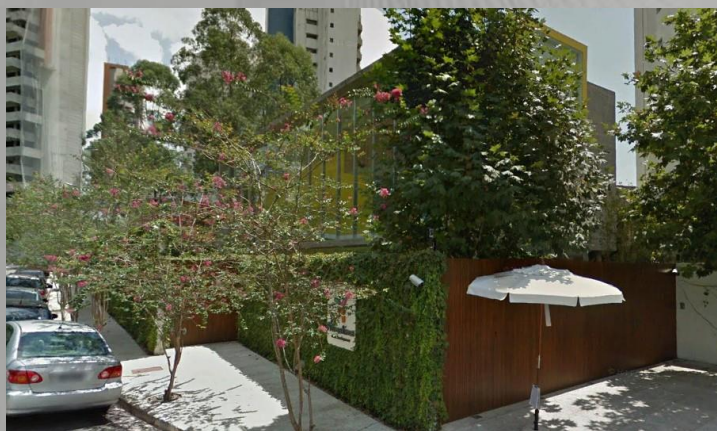

幼儿园的用地面积包括建筑占地、室外活动场地绿化及道路用地等。



在仅有900m²的占地面积中，如何实现
对场地的控制？

平面生成

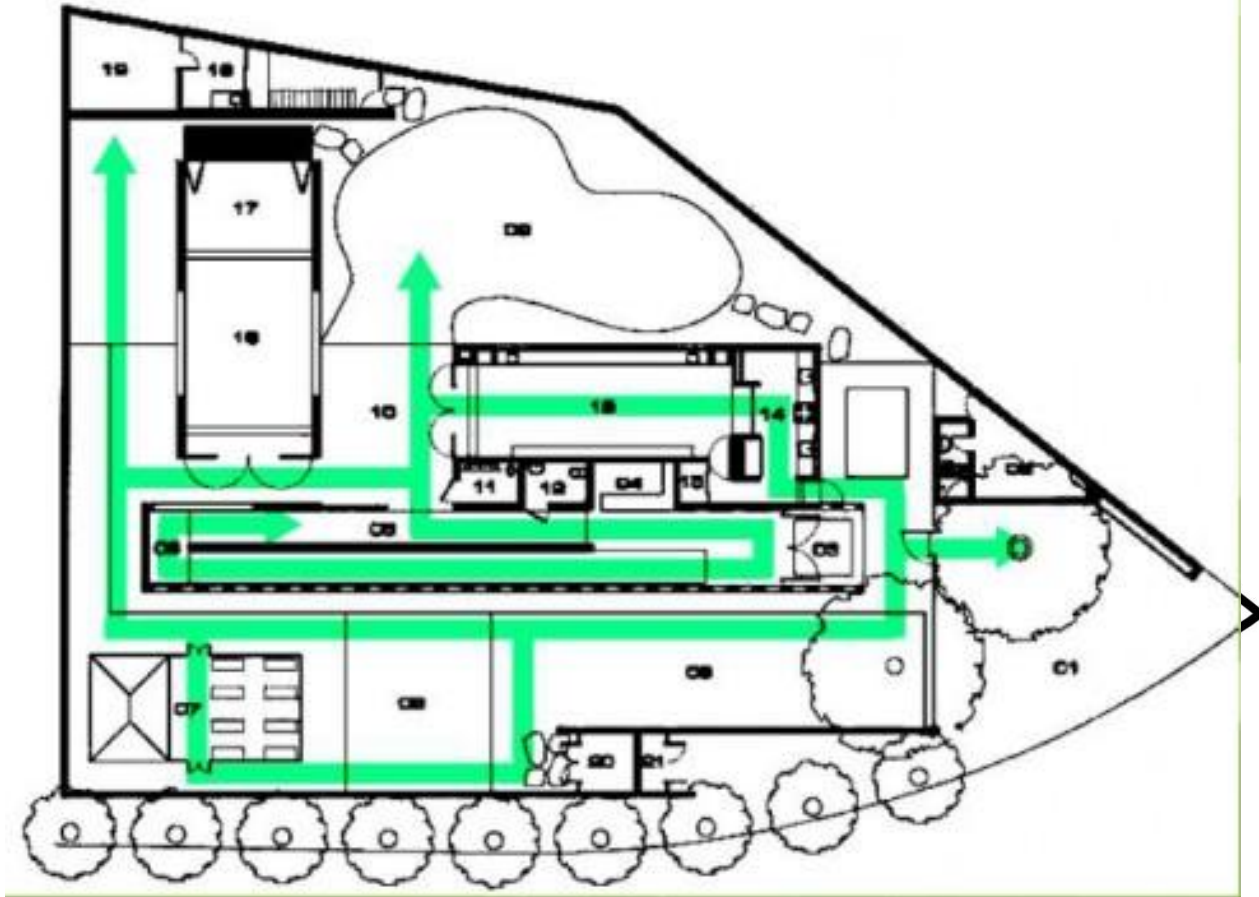

空间生成



空间生成

建筑形体以矩形体块的拼接为主，规矩的布局与形体的穿插形成了穿越式的空间。

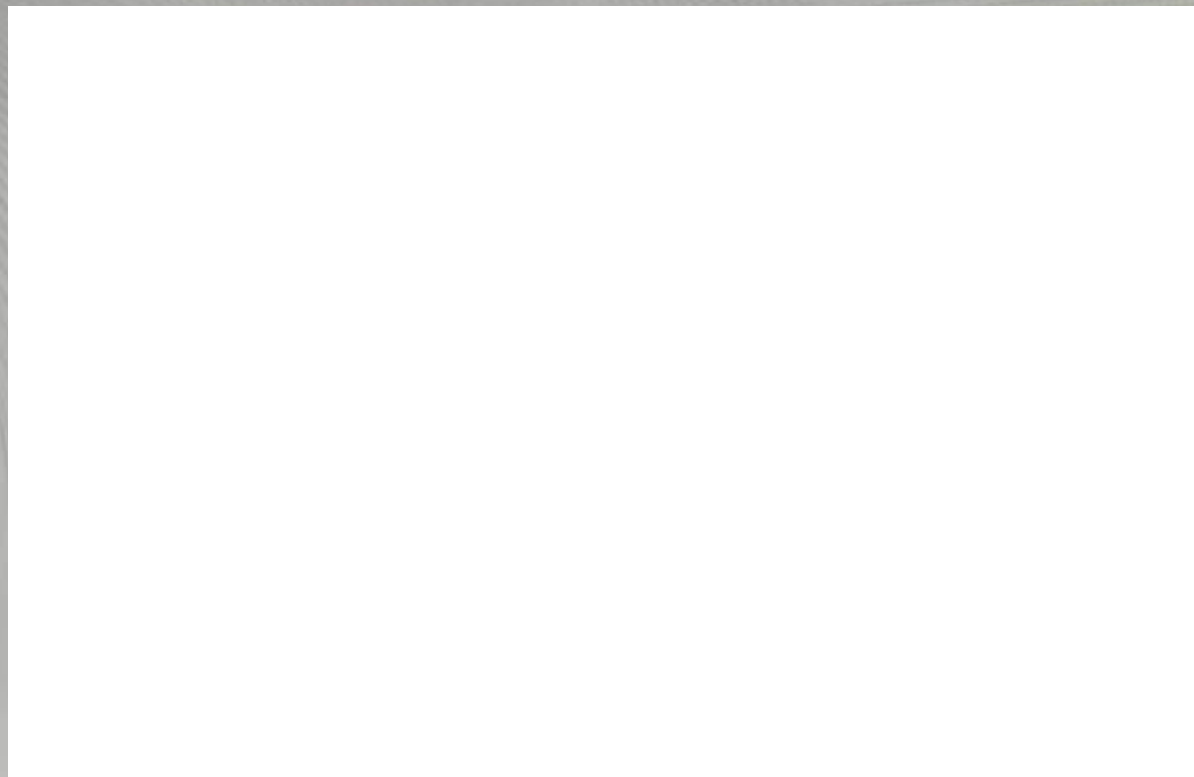

如何做到体块的
悬浮效果???





支撐的柱子

支撑的柱子

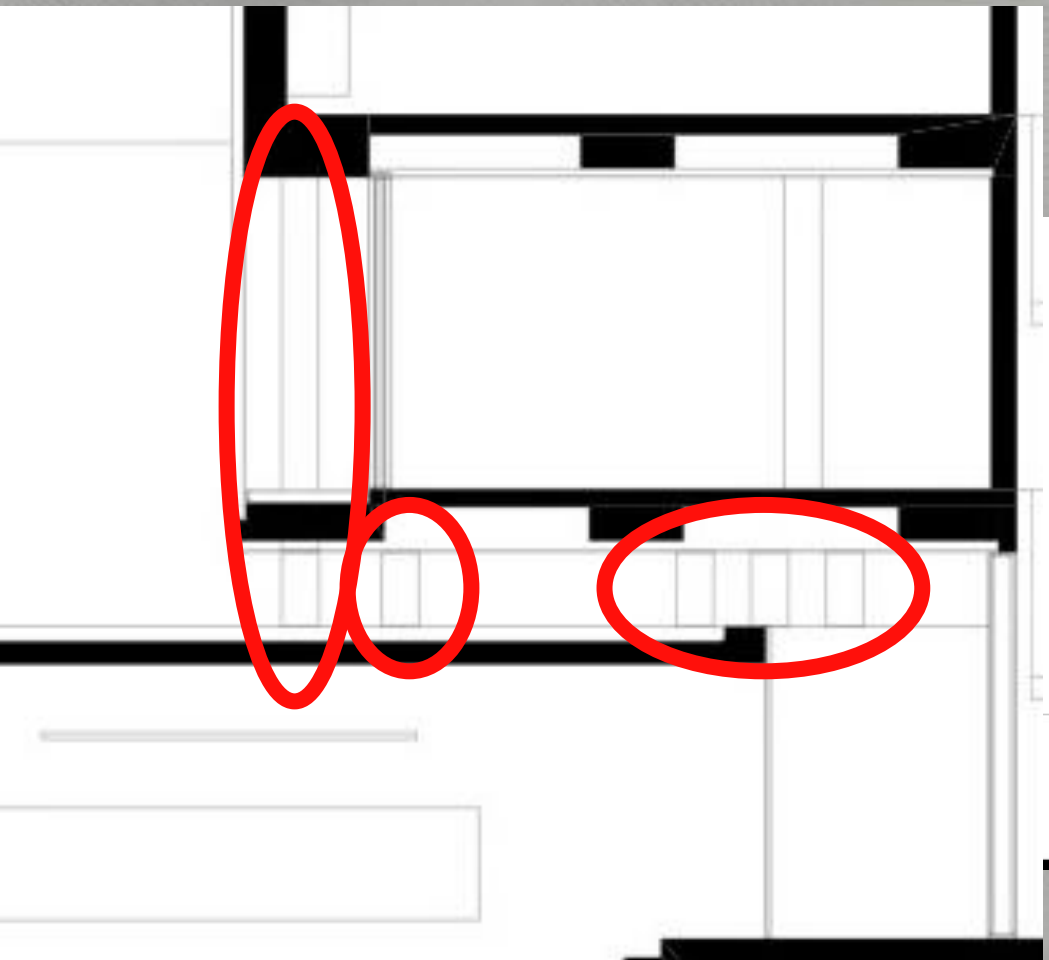

穿过二楼支撑三楼的柱子

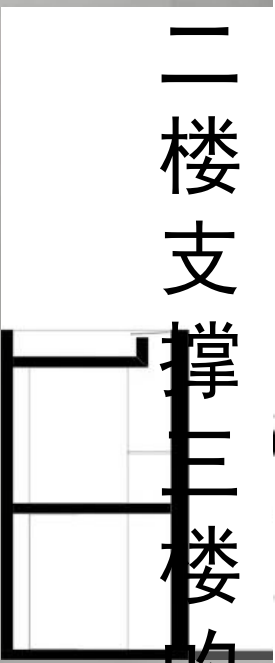

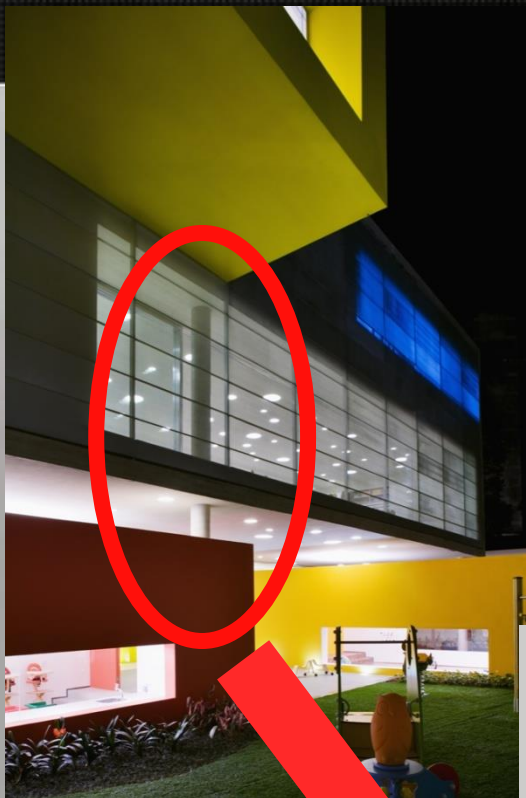

所有的
七根柱子都
落在一层的
柱管上

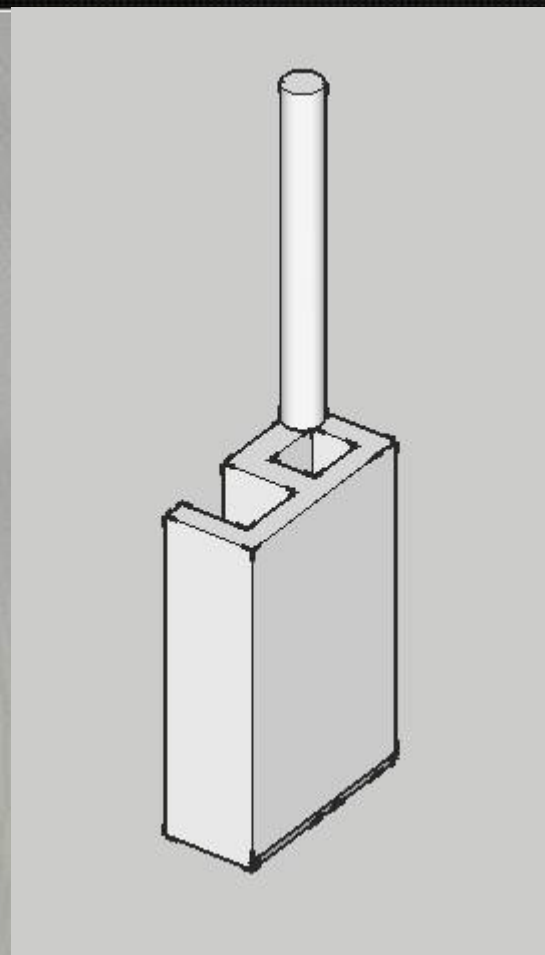
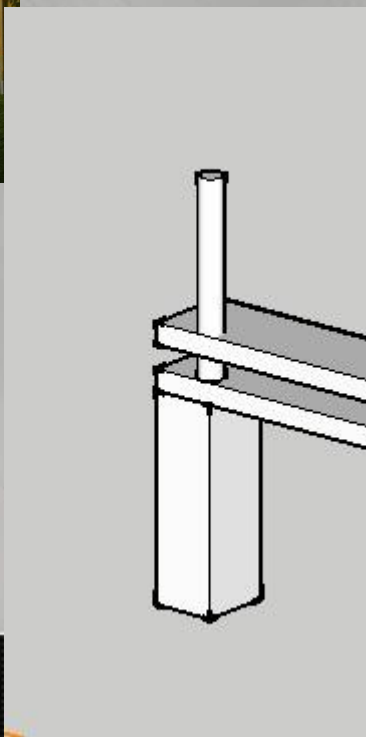

色彩探究

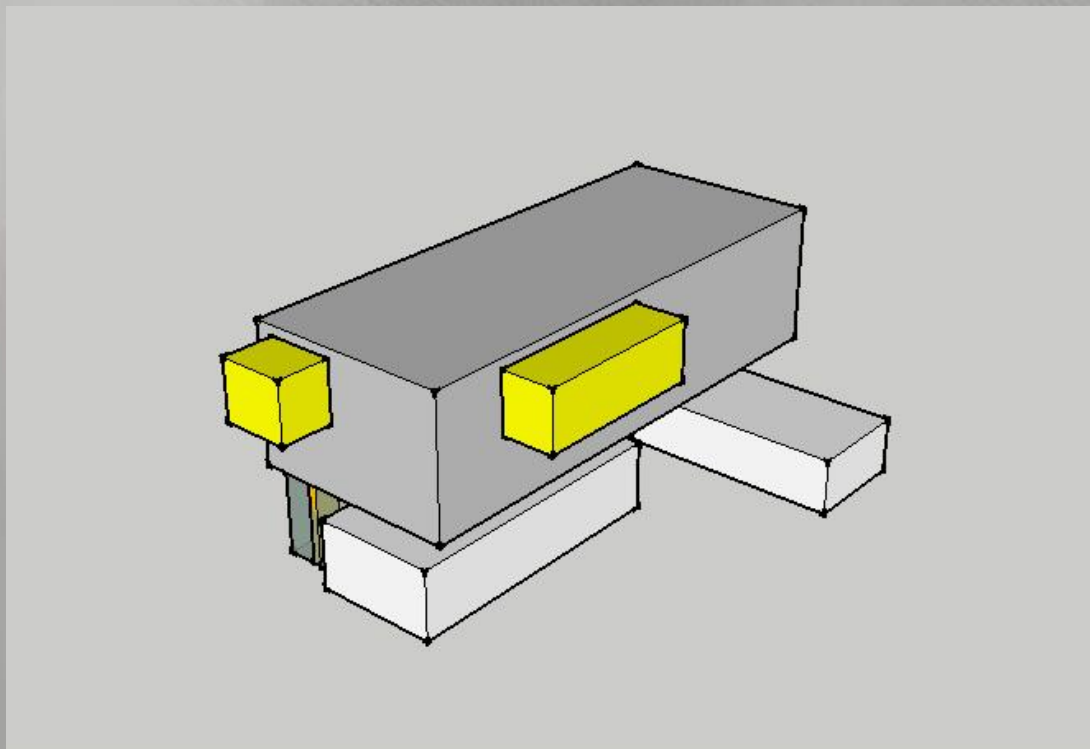

先将主要体块表面
涂刷黄色，黄色
明度最高，醒目，
将其放在二楼的
其余体块涂上
颜色。



红橙黄这三种颜色，
有着是人愉悦的功能，
很适合幼儿园的使用。

色彩探究

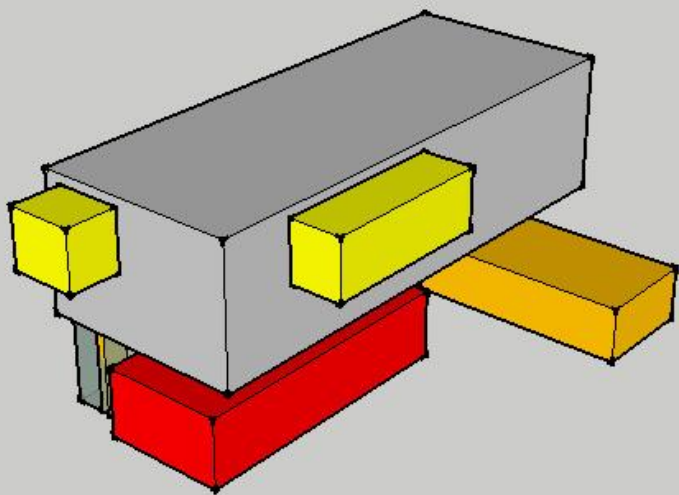

体积比

→ 2 : 3 : 5

橙与黄色相相近，
将大体积的体块
漆上红色，使颜
色平衡。



THANK YOU