

LOCALIZATION

文脉

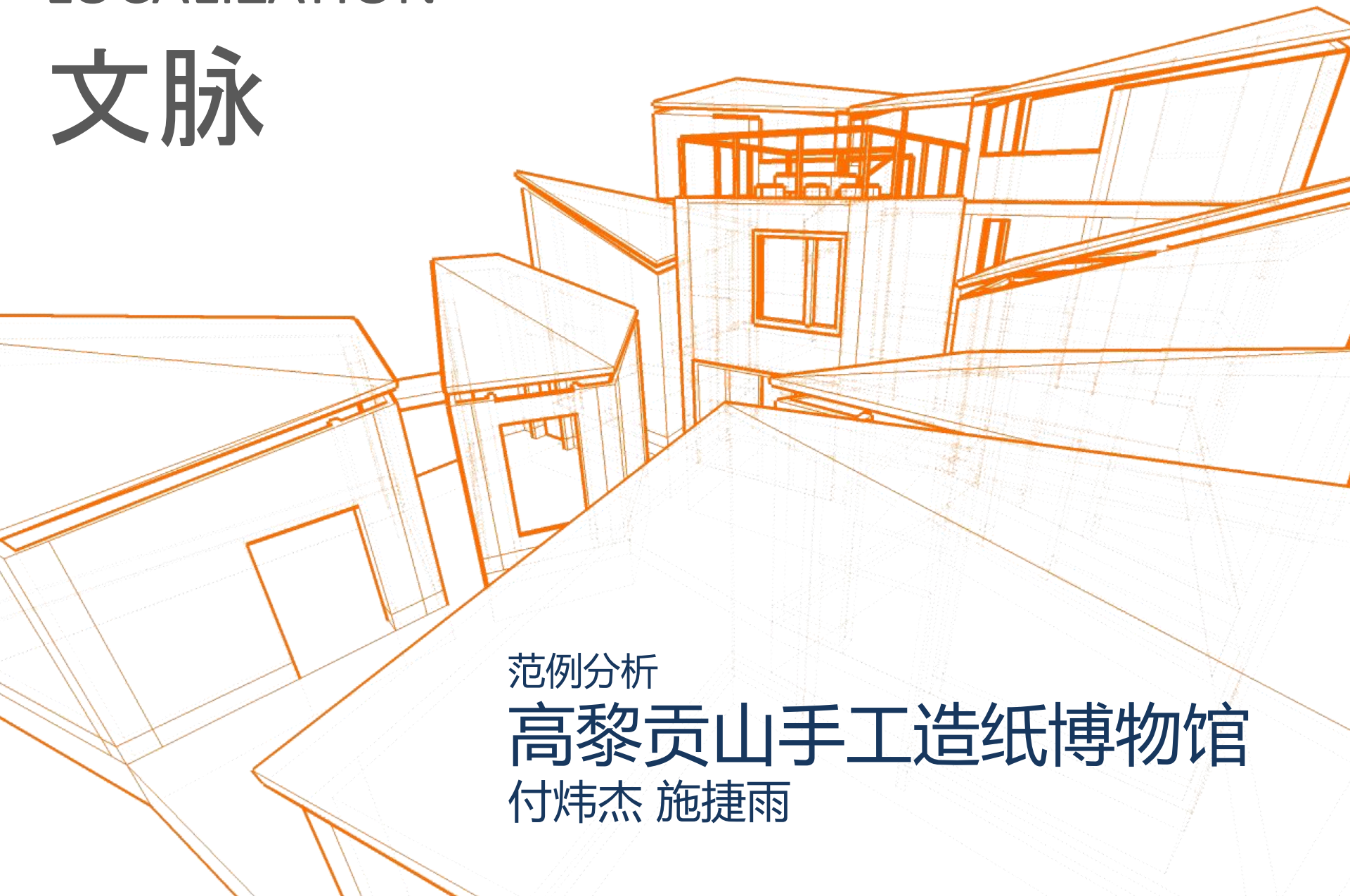

范例分析

高黎贡山手工造纸博物馆

付炜杰 施捷雨

对文脉的分析是去理解场地的原有条件、场所、精神以及它的自然、视觉、听觉和其他方面的主要因素。

腾冲

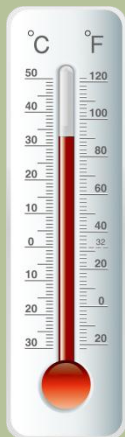

← 30.5°C

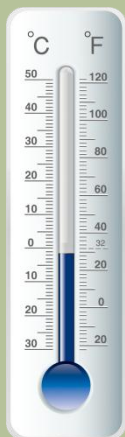

14.9°C

← -4.2°C



MOUNTAIN

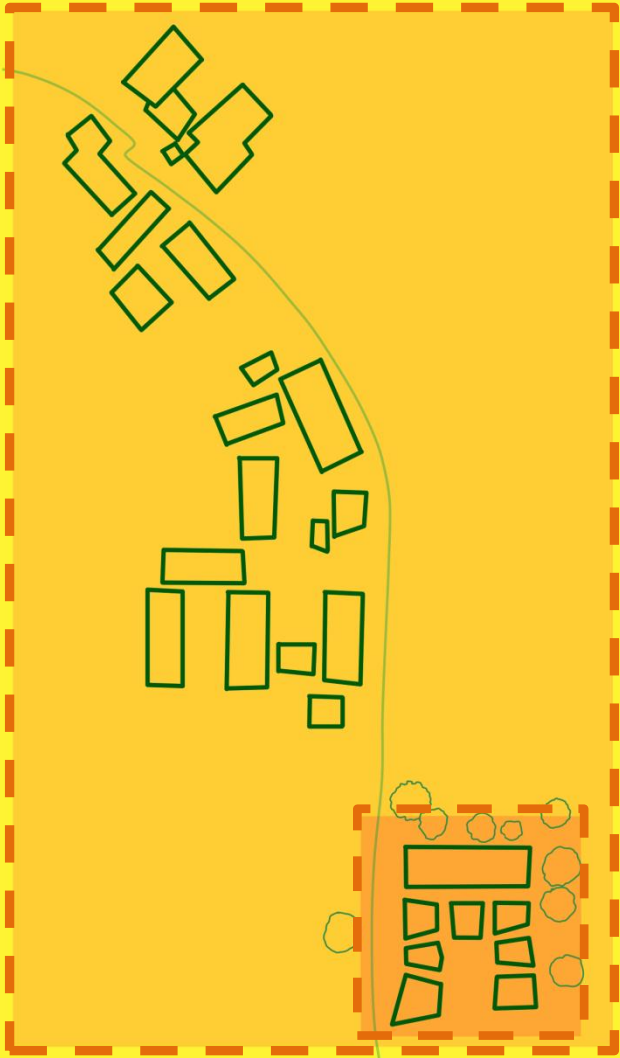



U形

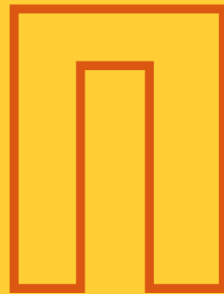

聚落



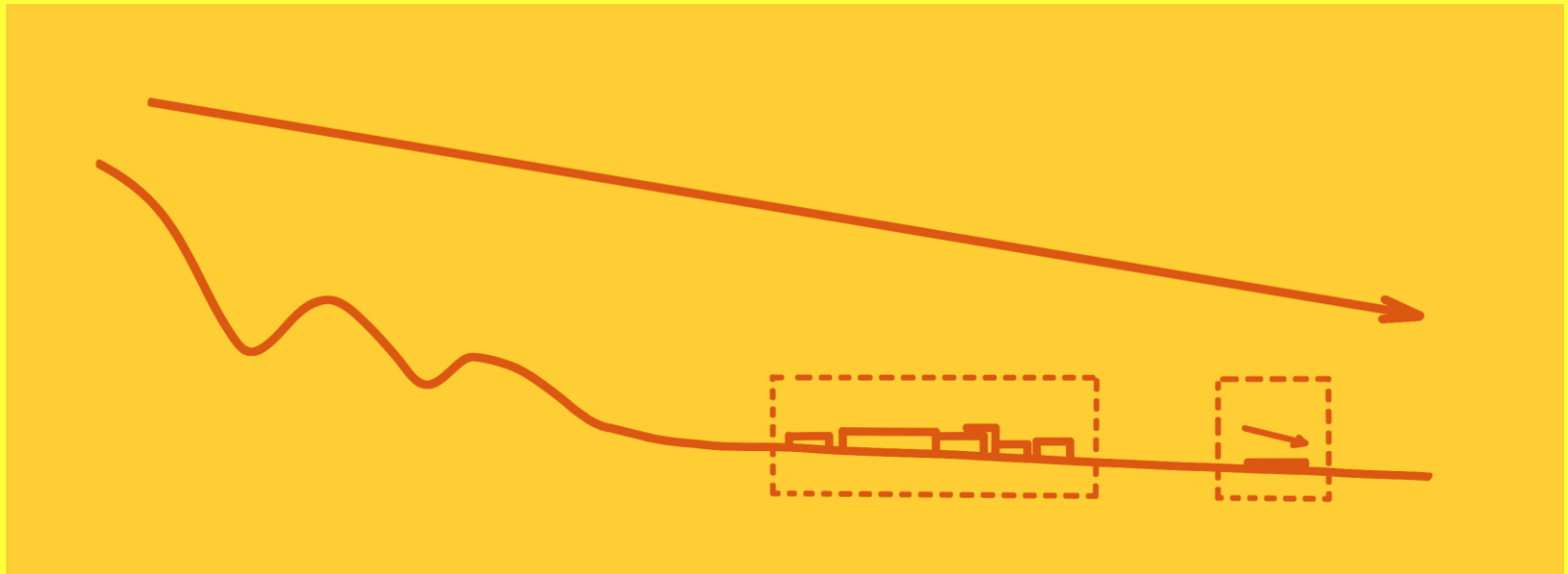

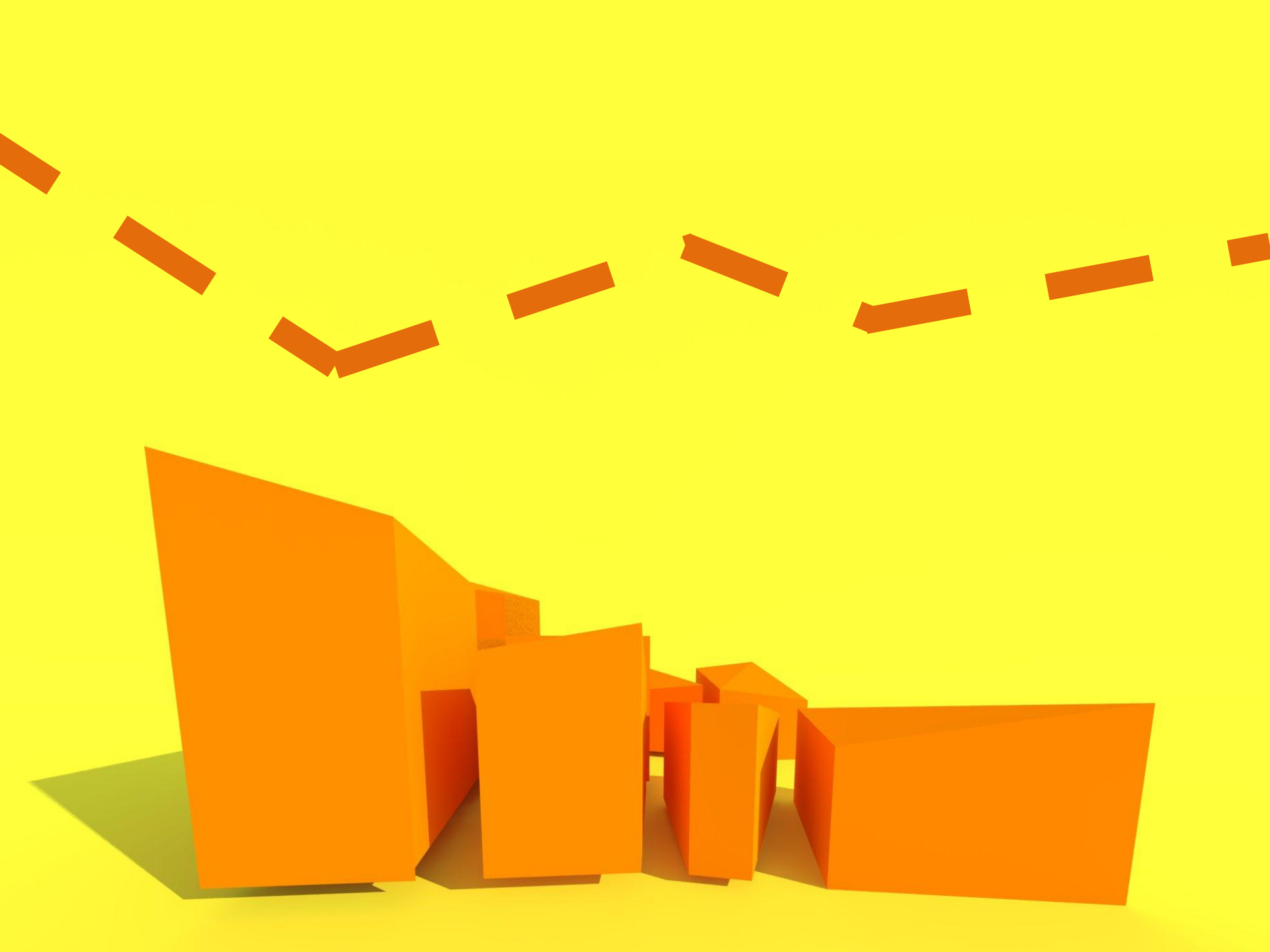

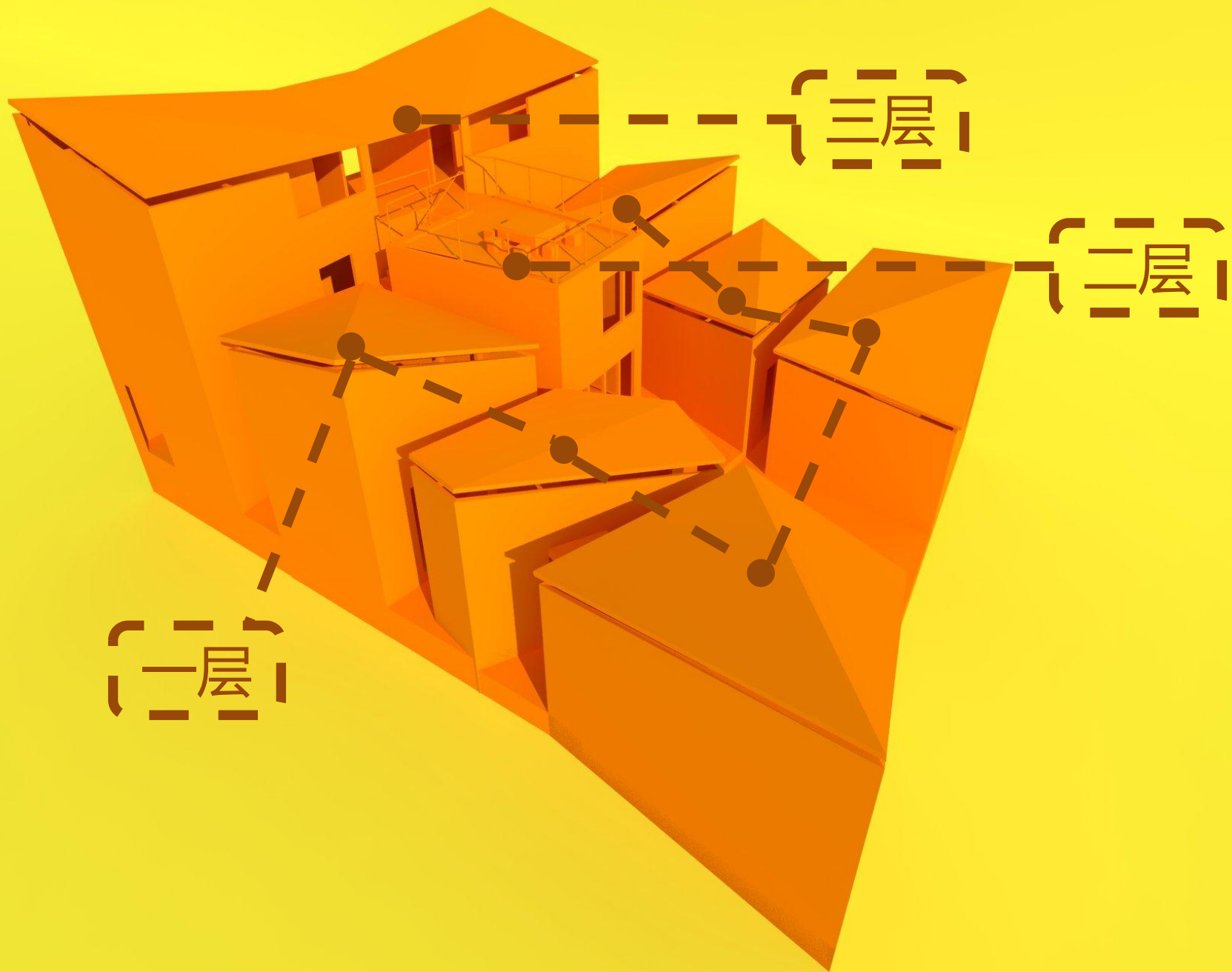

参观流线



其他流线

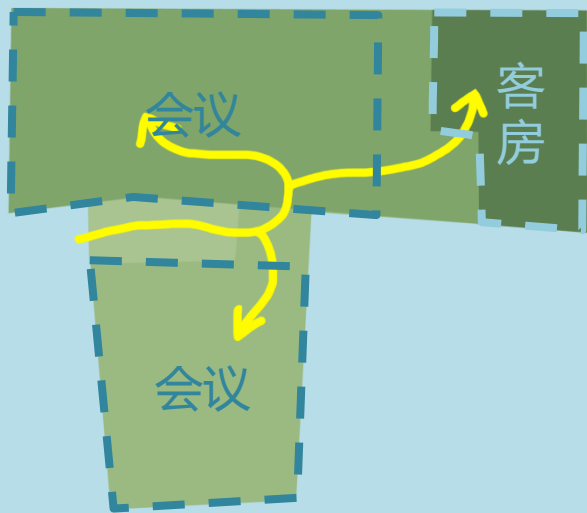

二层流线

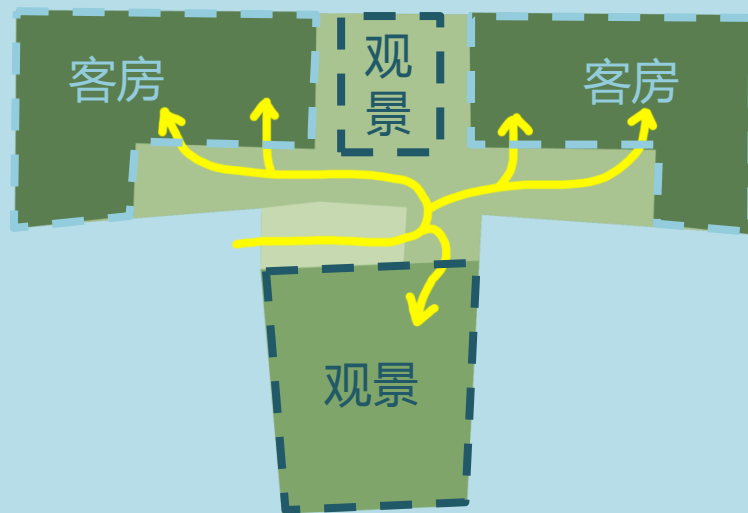

三层流线



木竹石纸

木结构

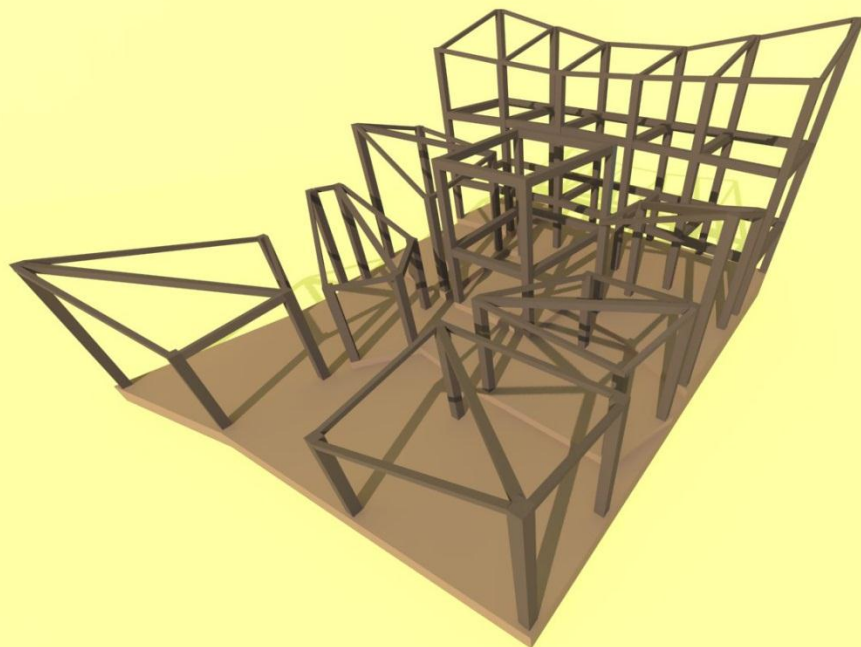

墙面



木

铺地



石

柱础



屋顶



竹

内墙



纸

细部分析

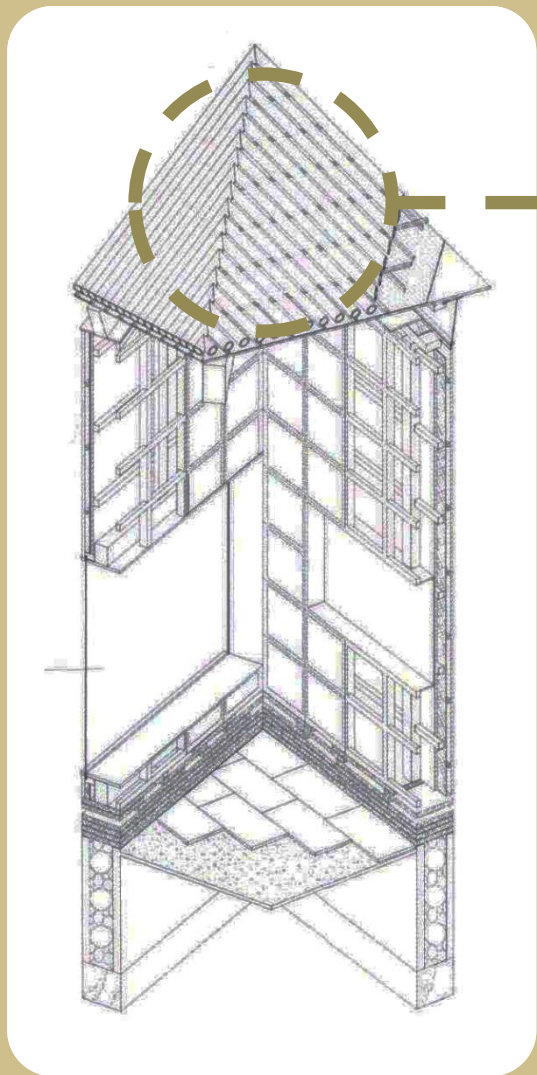

“截大竹丈余，平破开，去其节编之，又以破开竹覆其缝，脊檐则横竹夹定”

——《竹室记》·房千里

细部分析

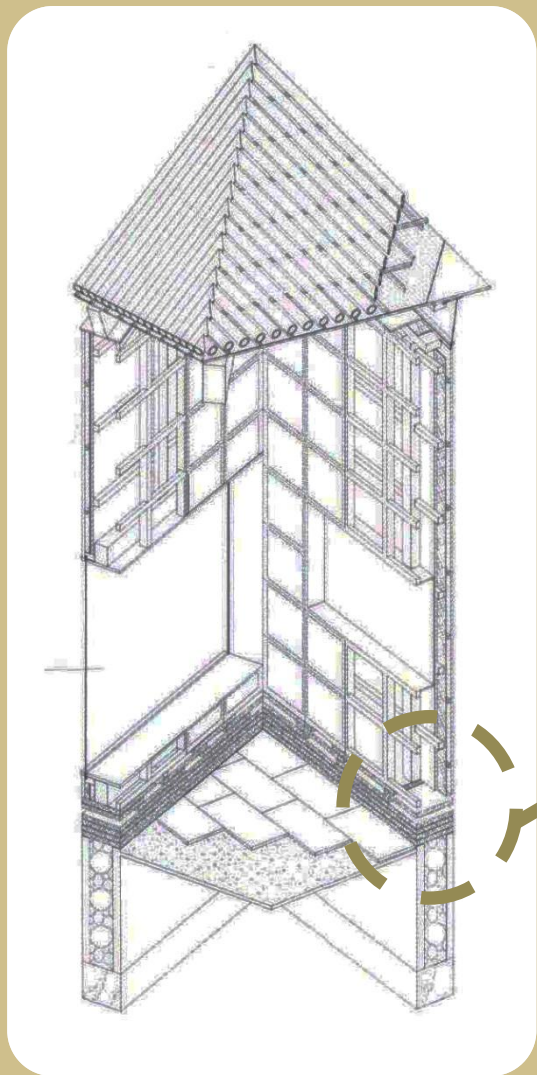

细部分析

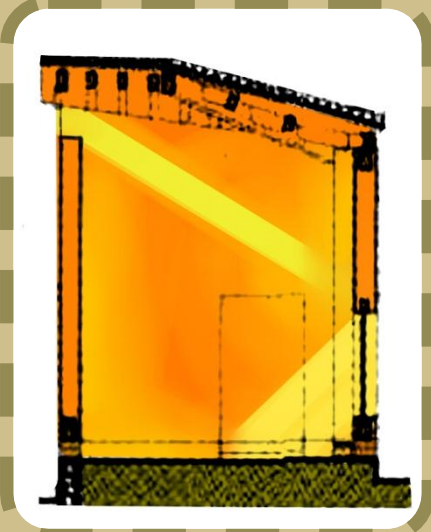
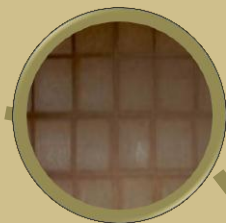
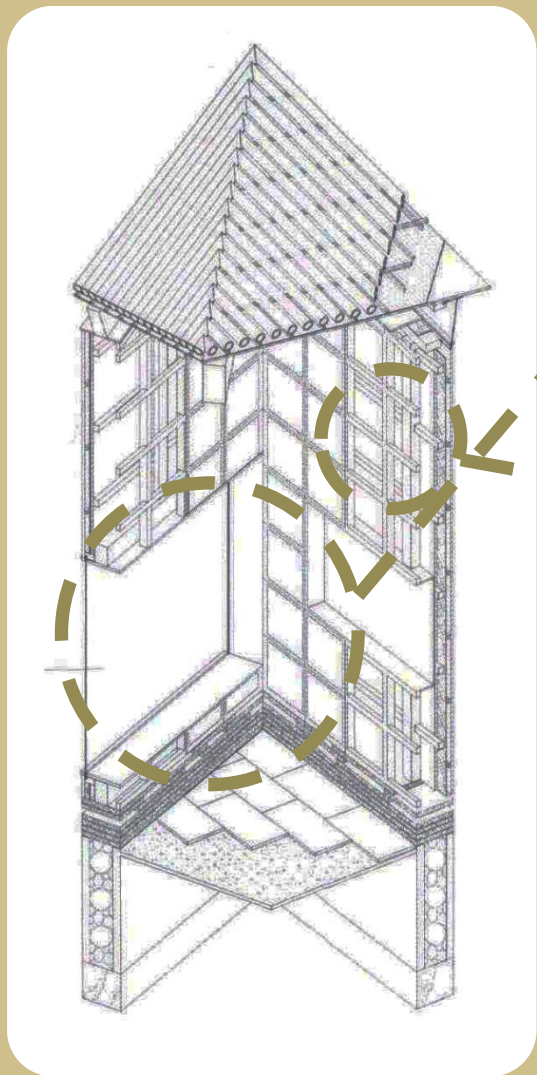

细部分析

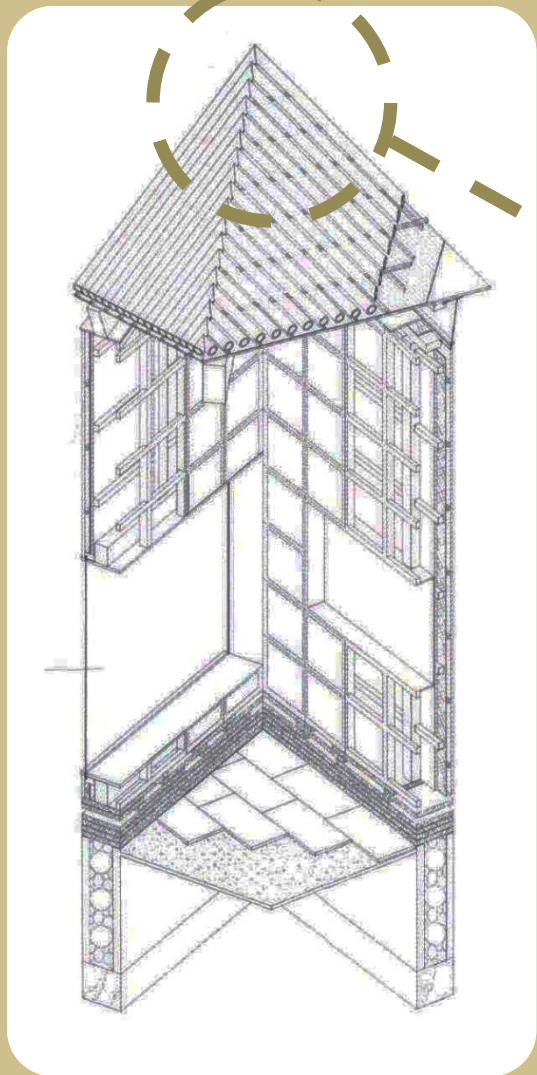

视线与过渡空间

